

Round Base

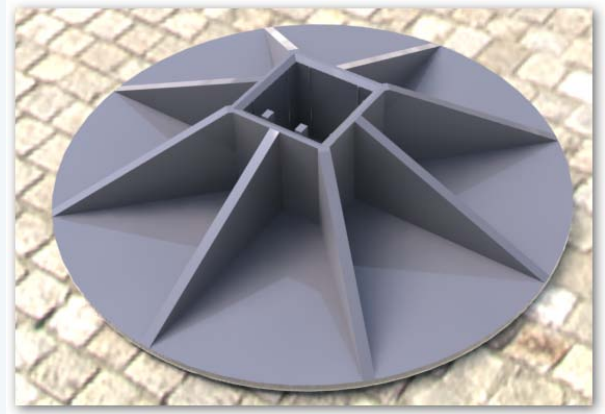

ROUND BASE

Round Base was studied for the installation of any unit on any surface. It represents a stable and safe support for any air treatment unit, chillers, pipes, refrigerant groups, platform, access ramps to be installed on roofs.

ADVANTAGES IN THE USE OF THE ROUND BASE SYSTEM

⇒ **Reduction in the carrying out times :**

Thanks to the mounting easiness, the Round Base allows to reduce projecting and installation times.

⇒ **Reduction of maintenance costs:**

It won't be necessary to carry out additional proofing interventions, switch the plants off for the usual roofs maintenance or make repair works in case of replacement of an equipment.

⇒ **Reduction of intervention costs:**

The easiness in the carrying out of modular frames allows to make structures with modification in a very short time during and after the installation of the equipments.

ACHIEVEMENTS

Combining the modular structures, bases, legs, crossbars, stirrups and clamps in a proper way, you can easily make any structure.

This will allow you to make supporting systems for air ducts, pipes, ducts for carrying cables air treatment units, platforms, solar panels.



" You can carry out any structure "

VERSATILITY

The peculiarity and flexibility of Round Base system allow us to transform the frames following our present and future requests, without structural modifications on supporting surfaces. Round Base shape assures us the maximum adaptability to the laying surface without damages to the proofing works.





PLANTS TYPOLOGY

With round base system you can make supports for:

- ◇ *Pipes*
- ◇ *Extractors*
- ◇ *Air treatment units*
- ◇ *Ducts for carrying cable*
- ◇ *Roof-tops*
- ◇ *HVAC equipments*
- ◇ *Condensers*
- ◇ *Evaporators*
- ◇ *Platforms*

- ◇ *Thanks to its flexibility we can make frames even in the most critical conditions, without intervention on the proofing membrane.*



QUALITIES

- ◆ *INNOVATIVE SYSTEM*
- ◆ *REDUCED PROJECTING TIMES*
- ◆ *MAXIMUM FLEXIBILITY*
- ◆ *NO INTERVENTION ON PROOFING
MEMBRANE*
- ◆ *EASINESS IN LOADINGS DISTRIBUTION*
- ◆ *INSTALLATION EASINESS*

TECHNICAL FEATURES

- *Material: DURETHAN BKV (polyamide 6 reinforced with glass fibre at 30%)*
- *Base diameter: Ø 248 mm*
- *Dimension of supported lines: 41 x 41 mm*
- *PATENTED MODEL*

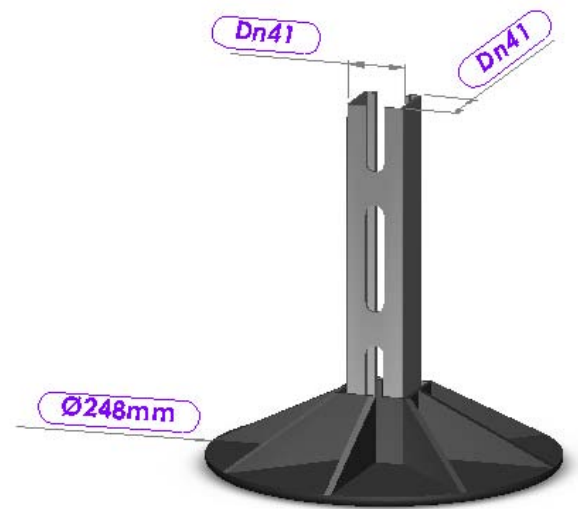

" Example of modular frame "



Tecnoelettra s.r.l.

Via per Cadrezzate 11
21020 Brebbia (VA)
ITALY

Tel.: +39 (0) 332 772000

Fax: +39 (0) 332 772205

